

Operation Manual

Caution: Take Safety Precautions When Using Your Toolbox

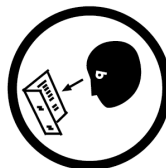

IMPORTANT:

THIS OPERATING MANUAL CONTAINS IMPORTANT SAFETY INFORMATION. READ CAREFULLY AND UNDERSTAND ALL INFORMATION BEFORE OPERATING STORAGE CABINET. SAVE THIS MANUAL FOR FUTURE USE



Do not open more than one drawer at a time.



Do not step on drawers.



Do not let children near the Toolbox.

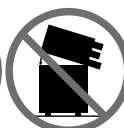

Do not separate Chest from Trolley.



Do not exceed Drawer Load Limit



Not suitable for mounting in Vehicles

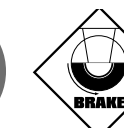

Set the brake on the locking castors unless you are moving the Toolbox.



Lock drawers and lid before moving the Toolbox.



Parts List



Keys x 6



16 x 12mm Bolts for Castors

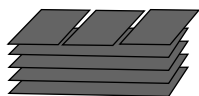

10 x EVA Liners

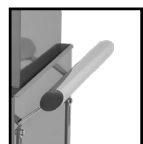

Handle x 1



Screws;
4 x Short,
4 x Long
(Screwed into
Removeable Panel)



Side Parts Tray x 1

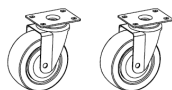

Non-Locking Castors x 2



Locking Castors x 2

TOOL CHEST SPECIFICATIONS

	Width	Depth	Height
Overall	648mm	315mm	480mm
Top Section	605mm	310mm	145mm
Small Drawers			
Shallow	175mm	260mm	38mm
Large Drawers			
Shallow	580mm	260mm	38mm
Deep	580mm	260mm	65mm

TOOL TROLLEY SPECIFICATIONS

	Width	Depth	Height
Overall	765mm	460mm	1105mm
Overall (w/o Castors)	765mm	460mm	955mm
Top Section	765mm	455mm	15mm
Drawers			
Shallow	605mm	395mm	55mm
Deep	605mm	395mm	135mm
Cabinet	675mm	435mm	555mm
Side Parts Tray	80mm	440mm	75mm
Castors	125 x 50mm (5 x 2") 2 x Locking		
Weight	45.8kg		

OVERALL SPECIFICATIONS

	Width	Depth	Height
Overall	765mm	460mm	1570mm
Overall (w/o Castors)	765mm	460mm	1415mm
Weight	69.8kg		

TOOLS & ASSISTANCE NEEDED



2 People Lift

Removing Chest



12mm Spanner +
Phillips Screwdriver

Castor

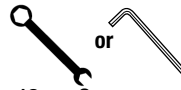

12mm Spanner or
5mm Hex Key

Handle



10mm Spanner

Assembly Instructions

- 1 REMOVE PRODUCT FROM CARTON AND STAND UNIT UPRIGHT
- 2 UNLOCK THE TROLLEY AND REMOVE THE HANDLE, CASTORS AND SIDE PARTS TRAY FROM THE DEEP DRAWER
- 3 LOCK UNIT, THEN FLIP UNIT UPSIDE DOWN

- 4 UNLOCK CABINET, THEN OPEN CABINET DOORS. LOCATED INSIDE IS THE CHEST, AND 4 BOLTS SECURING IT ON A WOOD PANEL
These are holding the chest down and need to be removed using a 12mm Spanner or 5mm Hex Key.

NOTE: Bolts need to be kept for castor installation further in the process.

- 5 REMOVE THE REMOVEABLE PANEL FROM THE REAR OF THE TROLLEY USING A PHILLIPS SCREWDRIVER.

Unscrew the 8 screws from the removeable panel. Save the screws to reinstall the panel later. There are 4 short screws and 4 long screws that come out. Ensure they go back in the same place.

NOTE: Short Screws at the bottom of the Panel, and longer screws at the top.

- 6 REMOVE THE CHEST FROM THE TROLLEY FROM THE REMOVEABLE PANEL ACCESS

- 7 WITH THE UNIT STILL UPSIDE DOWN, REINSTALL THE BACK PANEL AND SCREWS, WITH SHORT SCREWS AT THE TOP, AND LONGER SCREWS AT THE BOTTOM

Please refer to pictures in Step 5.

- 8 MOUNT THE CASTORS TO TROLLEY.

Ensure both Lockable Swivel Castors are located at the front of the trolley for easy locking when in use, and tighten using a 12mm Spanner or 5mm Hex Key.

- 9 LOCK UNIT, AND FLIP TO THE CORRECT ORIENTATION.

- 10 STANDING THE TROLLEY UPRIGHT, INSTALL THE CHEST ON TOP OF THE TROLLEY.

- 11 INSTALL THE SIDE HANDLE AND SIDE PARTS TRAY TOGETHER.

First, place the Handle in position and hold the Side Parts Tray in place whilst the second person screws in the bolts. This can be done on either left or right side of the trolley and will need a 10mm Spanner to tighten.

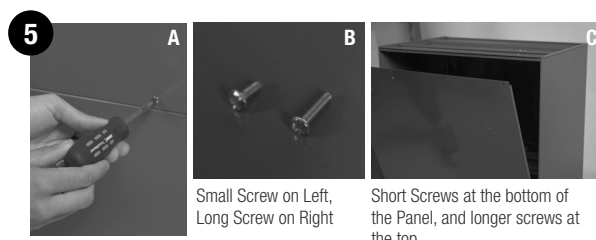
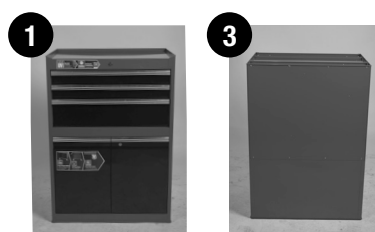

Maintenance

- Periodically tighten all hardware
- Periodically lubricate castors
- Lubricate the slides twice a year
- Lubricate the lock with graphite annually
- Use a damp Microfibre cloth to clean all surfaces

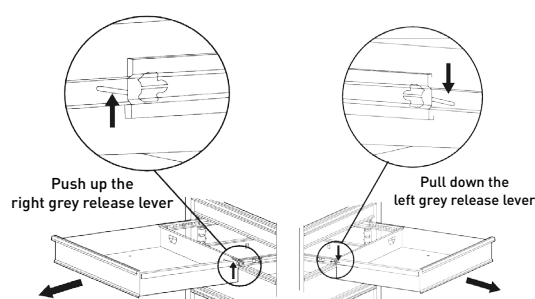

REMOVING THE DRAWERS

Fully extend the empty drawer. Push up the right grey release lever while pushing down the left grey release lever. Pull the drawer outward until it is released from the drawer slide.

RE-INSERTING THE DRAWERS

Extend the drawer slides. Insert the brackets on each side of the drawer into the slots on the slides, being careful that they are properly positioned. Once properly inserted, completely close the drawer to set the slides in their proper positions.

Replacement Parts



ITEM	PART NO.	DESCRIPTION	QUANTITY
1	K7529-1	Chest Lock & Key X 1	1
2	K7529-2	Trolley Lock & Key X 1	1
3	K7529-3	Cabinet Lock & Key X 1	1
4	K7529-4	Key Only X 1	1
5	K7529-5	Gas Strut (1 X Piece)	2
6	K7529-6	Chest Ball Bearing Slide (Pair)	6
7	K7529-7	Trolley Ball Bearing Slide (Pair)	3
8	K7529-8	Drawer Grip Small (Chest)	3
9	K7529-9	Drawer Grip Large (Chest)	3
10	K7529-10	Small Drawer (Chest)	3
11	K7529-11	Large Drawer (Chest)	2
12	K7529-12	Large Drawer Deep (Chest)	1
13	K7529-13	Rubber Grommet (1 X Piece)	2

ITEM	PART NO.	DESCRIPTION	QUANTITY
14	K7529-14	Side Carry Handle (Chest)	2
15	K7529-15	Eva Mat Pack (11 X Pieces)	1
16	K7529-16	Trolley Handle	1
17	K7529-17	Side Parts Tray	1
18	K7529-18	Large Drawer (Trolley)	2
19	K7529-19	Large Drawer Deep (Trolley)	1
20	K7529-20	Drawer Grip Large (Trolley)	3
21	K7529-21	Cabinet Door	2
22	K7529-22	Cabinet Hinges	4
23	K7529-23	Cabinet Grip	2
24	K7529-24	Castors Swivel (1 X Piece)	2
25	K7529-25	Castors Swivel Locking (1 X Piece)	2
26	K7529-26	Badge	1