



# TOOL TROLLEY

## 20 DRAWER SUPER WIDE BODY 60"

K7862

### Operation Manual

#### Caution: Take Safety Precautions When Using Your Toolbox



#### IMPORTANT:

THIS OPERATING MANUAL CONTAINS IMPORTANT SAFETY INFORMATION. READ CAREFULLY AND UNDERSTAND ALL INFORMATION BEFORE OPERATING TOOL TROLLEY. SAVE THIS MANUAL FOR FUTURE USE



Do not open more than one drawer at a time.



Do not step on drawers.



Do not let children near the Toolbox.



Do not separate Chest from Trolley.



Do not exceed Drawer Load Limit



Not suitable for mounting in Vehicles



Lock drawers and lid before moving the Toolbox.



### Parts List



### TOOL TROLLEY SPECIFICATIONS

Overall	Width	Depth	Height
(with castors)	1525mm	475mm	975mm
(without castors)	1525mm	475mm	790mm
Wide Drawers (Shallow)	650mm	400mm	65mm
Large Drawers (Shallow)	545mm	400mm	500mm
Medium Drawers (Deep)	545mm	400mm	134mm
Small Drawers (Shallow)	120mm	400mm	41mm
Small Drawers (Deep)	120mm	400mm	134mm
Side Tray	175mm	300mm	12mm
Castor Size:	125mm x 50mm (5" x 2") x 2 Locking		
Weight	165Kg		

### Assembly Instructions



Keys x 2



Trolley Handle x 1



8 x Hex Bolts for Push Handle



Power Handle x 1

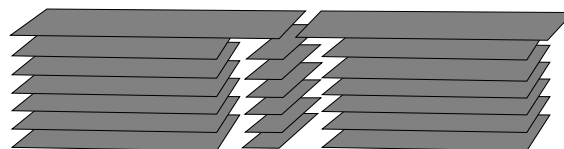

20 x EVA Liners

### TOOLS & ASSISTANCE NEEDED



2 People Lift

Handle



5mm Hex Key



# TOOL TROLLEY

## 20 DRAWER SUPER WIDE BODY 60"

K7862

### Assembly Instructions

**Step 1:** Get assistance to lift the trolley and slide the pallet from under the trolley. Castors are pre fitted.

**Step 2:** Using the 5mm Hex key provided, attach the 2 side trolley handles.



REVERSIBLE WORK SURFACE  
(STAINLESS STEEL OR MDF)

DUAL TROLLEY HANDLES

FOLDING SIDE SHELVES



LOCKABLE SWIVEL  
SUSPENSION CASTORS



#### STORAGE OPTIONS

Can Accept 1 Or 2 K7526 Black Series Contour Chests.  
(Sold Separately)

#### 1 Handle Installing

- Position the trolley side handle behind the holes on the trolley.
- Attach with (4) bolts, and tighten with a 5mm Hex Key.

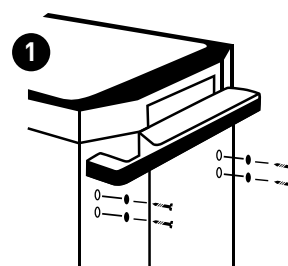

### Maintenance

#### 1 Removing the Drawers

- Fully extend the empty drawer.
- Push up the right grey release lever while pushing down the left grey release lever.
- Pull the drawer outward until it is released from the drawer slide.

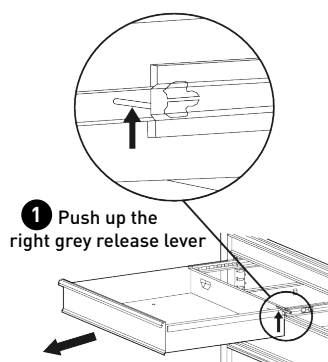

#### 2 Re-Inserting The Drawers

- Extend the drawer slides.
- Insert the brackets on each side of the drawer into the slots on the slides, being careful that they are properly positioned.
- Once properly inserted, completely close the drawer to set the slides in their proper positions.

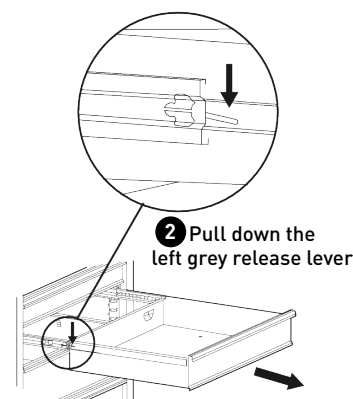

#### MAINTENANCE

- Periodically tighten all hardware
- Periodically lubricate castors
- Lubricate the slides twice a year
- Lubricate the lock with graphite annually
- Use a damp Microfibre cloth to clean all surfaces



# TOOL TROLLEY

## 20 DRAWER SUPER WIDE BODY 60"

K7862

### Replacement Parts



### REPLACEMENT PARTS

ITEM	PART NO.	DESCRIPTION	QUANTITY	ITEM	PART NO.	DESCRIPTION	QUANTITY
1	K7778	Lock & Key	1	6	K7747-16	Ball Bearing Slides Pair (2)	20
2	K7779	Key Only (Specify Number)	1	7	K7862-13	Swivel Castor (1)	4
3	K7862-2	Plastic Trolley Top (1)	1	8	K7862-14	Swivel Castor (Brake) (1)	2
4	K7759-5	Trolley Handle (1)	1	9	K7862-15	Castor Nut & Bolt Kit	1
5	K7741	Power Trolley Handle	1	10	K7862-17	Eva Mat Pack (20)	20

**KINCROME**  
TOOLS + EQUIPMENT™

National Head Office  
National Distribution and Showroom  
3 Lakeview Dve, Caribbean Business Park  
Scoresby Victoria 3179 Australia  
ABN 41 007 185 006

Administration  
T +61 3 9730 7100 F + 61 3 9730 7199  
E [enquiries@kincrome.com.au](mailto:enquiries@kincrome.com.au)  
W [kincrome.com.au](http://kincrome.com.au)

Customer Service Centre  
T 1300 657 528 F 1300 556 005

Made to Kincrome Tools & Equipment Pty Ltd Global specifications and quality standards in China  
Kincrome UK Ltd PO Box 646 EASTLEIGH S050 0NA

Australia & Global	UK & EU
<a href="http://www.kincrome.com.au">www.kincrome.com.au</a>	<a href="http://www.kincrome.co.uk">www.kincrome.co.uk</a>
<a href="mailto:enquiries@kincrome.com.au">enquiries@kincrome.com.au</a>	<a href="mailto:enquiries@kincrome.co.uk">enquiries@kincrome.co.uk</a>